



Quick Start Guide

Deluxe 30 (921032 s/n 101 & up)

- Step 1: Assemble Handlebars
- Step 2: Connect Headlight Wire Harness
- Step 3: Install Discharge Chute
- Step 4: Install Discharge Chute Crank
- Step 5: Install Remote Deflector Control Cable
- Step 6: Install Skid Shoes
- Step 7: Check Function of Dual Handle Interlock
- Step 8: Check Tire Pressure
- Step 9: Check Auger Gearcase Oil
- Step 10: Check Engine Crankcase Oil
- Step 11: Fill Engine Fuel Tank
- Step 12: Start Engine
- Step 13: Stop Engine



READ AND UNDERSTAND ALL INSTRUCTION, WARNING, AND DANGER LABELS.
IMPORTANT: READ OPERATOR'S MANUAL AND ENGINE MANUAL THOROUGHLY AND FOLLOW THE IMPORTANT SAFE OPERATION PRACTICES BEFORE OPERATING.



Step One: Assemble Handlebars (Unfold Lower Handlebar)

IMPORTANT: Be sure to block wheels or secure unit so it does not move during assembly.

1. Rotate lower handlebar out from unit so lower handlebar mounting holes align with mounting holes on the unit frame.
2. Secure lower handlebar to unit using two 3/8 in. x 3/4 in. hex head serrated flange grade 5 bolts.
3. Tighten all four bolts to 25-42 lbf-ft (33,9-56,9 N·m)

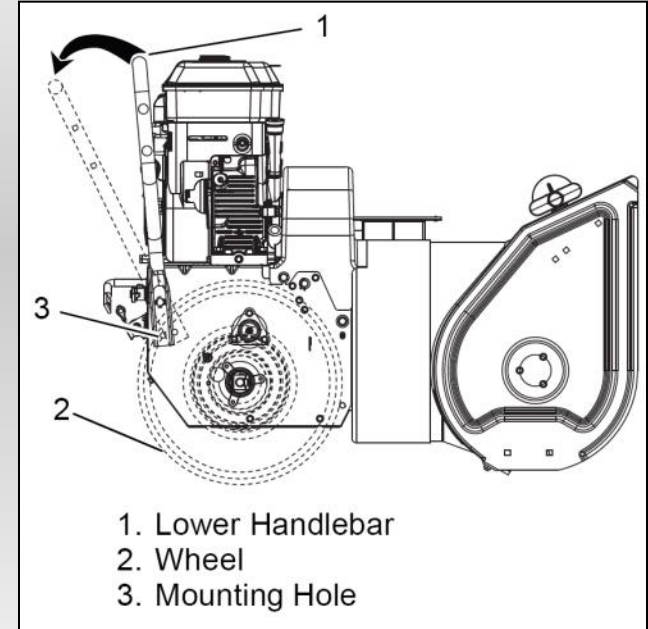



Step One: Assemble Handlebars (Attach Upper Handlebar Assembly)

1. Attach upper handlebar assembly to lower handlebar using two sets of the handlebar hardware. One set to attach each side of the handlebars.

NOTE: DO NOT tighten hardware. Allow upper handlebar assembly to hang from the lower handlebars for the next step.

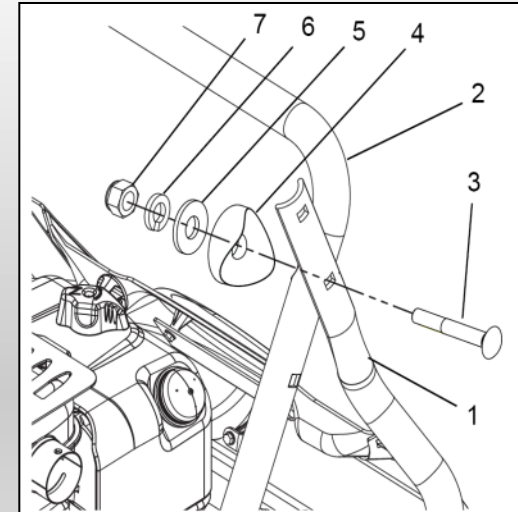

1. Upper Handlebar Assembly
2. Lower Handlebar
3. 5/16 in x 2-1/4 in. Round Head Square Neck Grade 5 Bolt
4. Handlebar Spacer
5. Flat Steel Washer
6. Locking Washer
7. 5/16 in Nyloc Nut





Step One: Assemble Handlebars (Attach Control Cables)

1. Hook spring end of attachment control cable to the clutch arm.
2. Hook spring end of the traction control cable to the cable eyelet on back of frame.

NOTE: Make sure cable remains in groove of pulley.

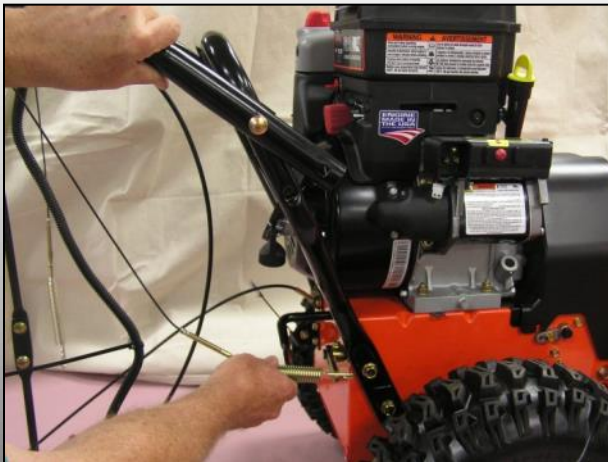
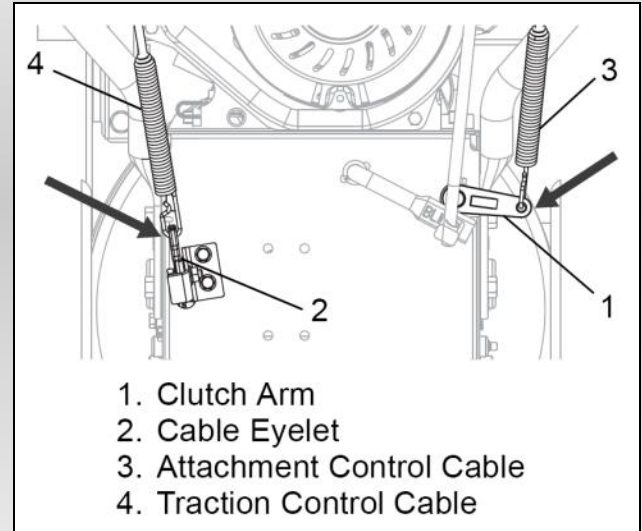



Step One: Assemble Handlebars (Unfold Upper Handlebar)

1. Rotate handlebar into operating position.

NOTE: Be careful not to damage cable spring hooks when rotating handlebar upward.

2. Install the remaining handlebar hardware attaching the upper handlebar assembly to the lower handlebar.
3. Tighten all hardware.
4. Remove packaging around shift rod.
5. Rotate shift rod into place and tighten hardware.
6. Connect shift rod to speed selector arm and adjust as specified. See *Selector Adjustment* in the Owners Manual.
7. Adjust attachment cable as specified. See *Attachment Clutch/Brake Adjustment* in the Owners Manual.
8. Adjust the traction cable as specified. See *Traction Drive Clutch Adjustment* in the Owners Manual.

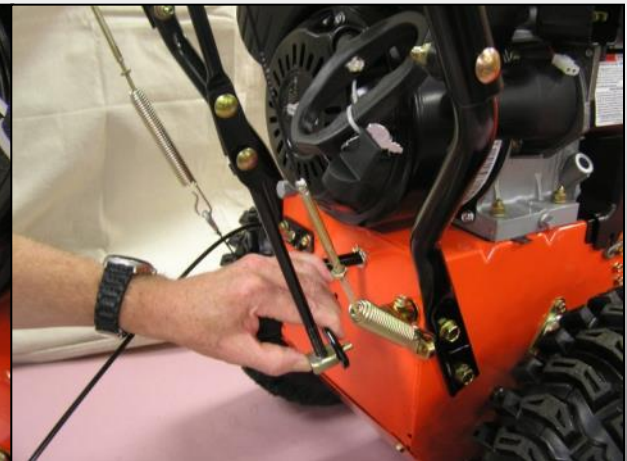
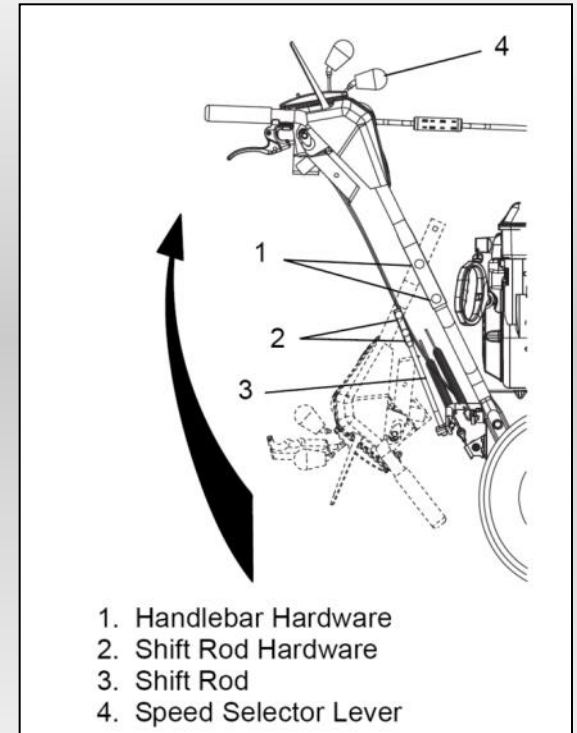



Step Two: Connect Headlight Wire Harness

NOTE: The headlight wire harness comes attached to the upper handlebar assembly.

1. Route the wire harness along the interior of the right side handlebar.
2. Connect to the engine electrical plug.
3. Press cable anchor into mounting hole in the frame near the engine electrical plug.
4. Secure the wire harness to the handlebars using the cable ties attached to the wire harness.

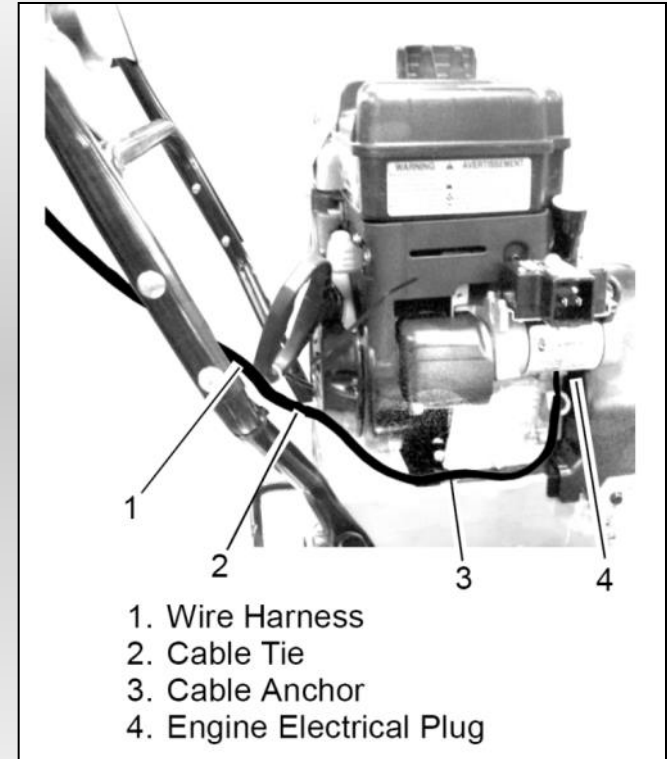



Step Three: Install Discharge Chute

1. Grease underside of discharge chute ring (if not already greased).
2. Remove mounting hardware from auger housing.
3. Install discharge chute over opening in the auger housing. Finger tighten the mounting hardware removed above.

NOTE: Leave discharge chute pedestal loose to help install the chute crank.

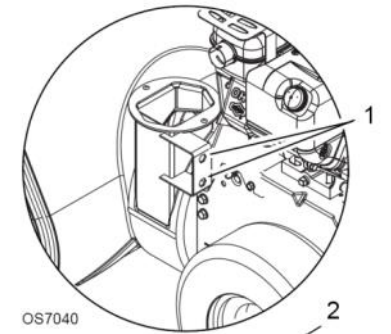

OS7040

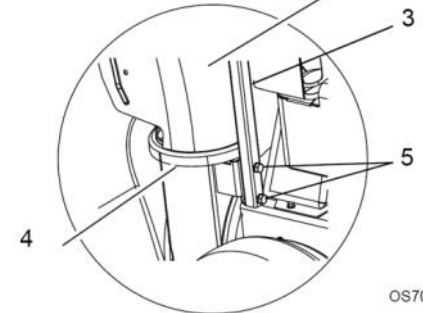

OS7045

1. Mounting Holes
2. Discharge Chute
3. Chute Pedestal
4. Discharge Chute Ring
5. Mounting Hardware





Step Four: Install Discharge Chute Crank

1. Remove the gear cover from top of chute pedestal.
2. Insert the short end of the chute crank into the hole in the front of the control panel.

NOTE: Be careful not to damage nylon bushing when attaching crank to the dash.

3. Connect the chute crank to the pinion gear on chute with hairpin.
4. Replace gear cover on top of chute pedestal.
5. Orient the chute and pedestal to its most vertical position and tighten pedestal hardware to 15 – 31 lbf-ft (20 – 42 N•m).

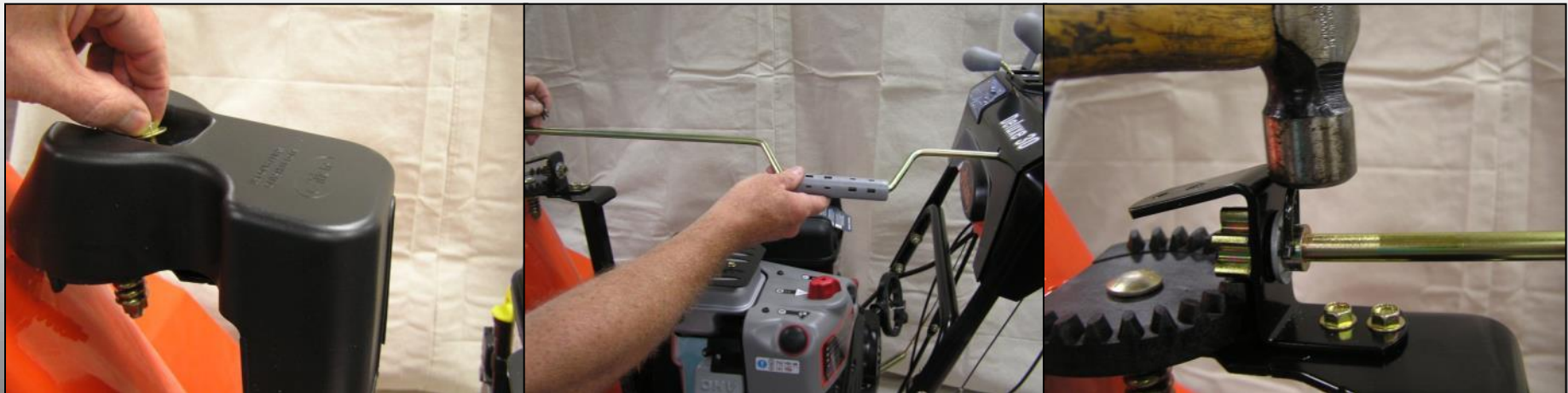
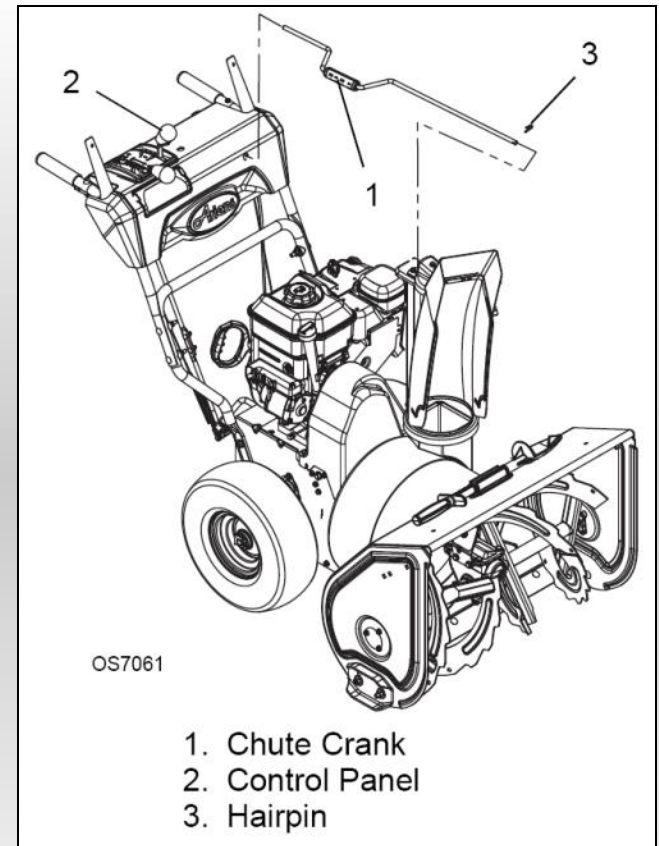



Step Five: Install Remote Deflector Control Cable

NOTE: Connect the barrel cable end to the chute deflector cable anchor before clipping the cable to the discharge chute cable bracket.

1. Route deflector remote cable along the left side of the chute pedestal.
2. Insert the barrel on the cable end into the bracket on left side of chute deflector.
3. Hold seal out of the way while routing the cable through the bracket on the left side of the discharge chute, and then push the cable fitting into the bracket.
4. Push the seal securely over the end on the cable fitting to prevent water from entering the cable.
5. Check deflector travel. Adjust nut on cable end under handlebar to obtain full travel, if necessary (see *Remote Deflector Control* in Owners Manual).

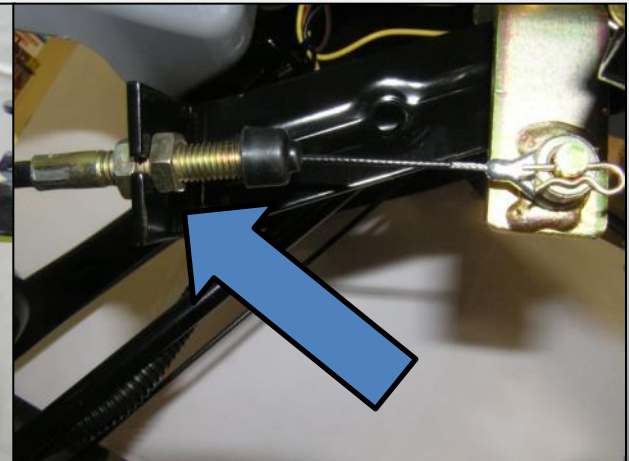
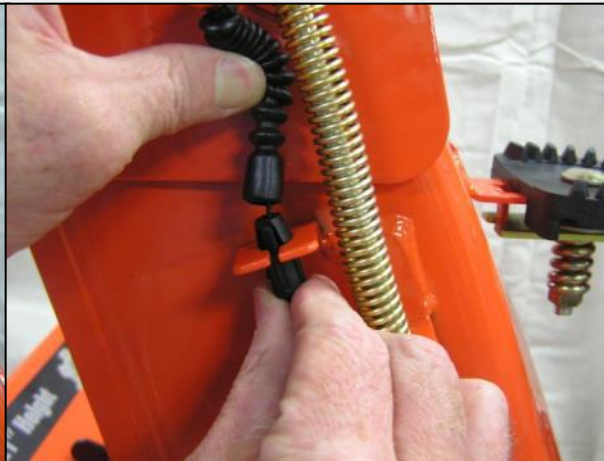
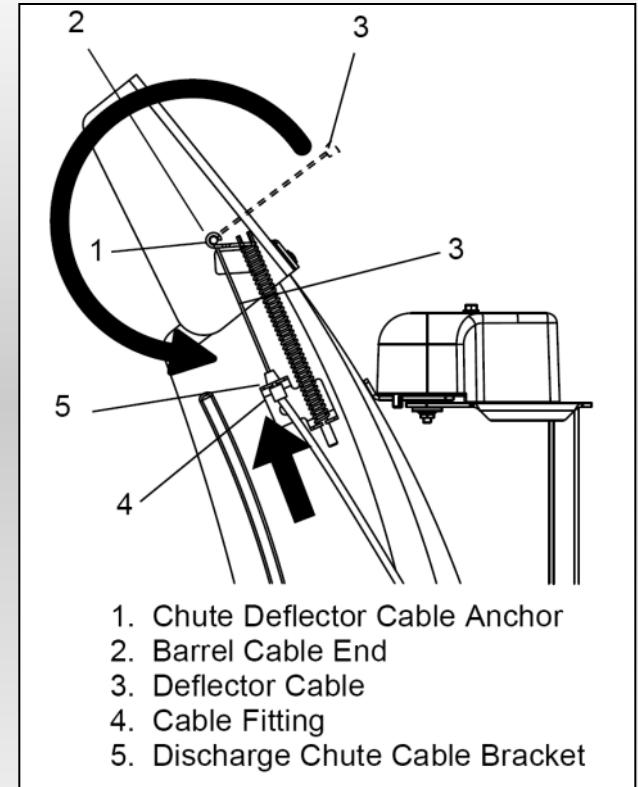



Step Six: Install Skid Shoes

1. Remove hardware from skid shoes.
2. Install hardware through blower housing and skid shoe as shown.
3. Adjust skid shoes, see *Skid Shoes* in Owners Manual.

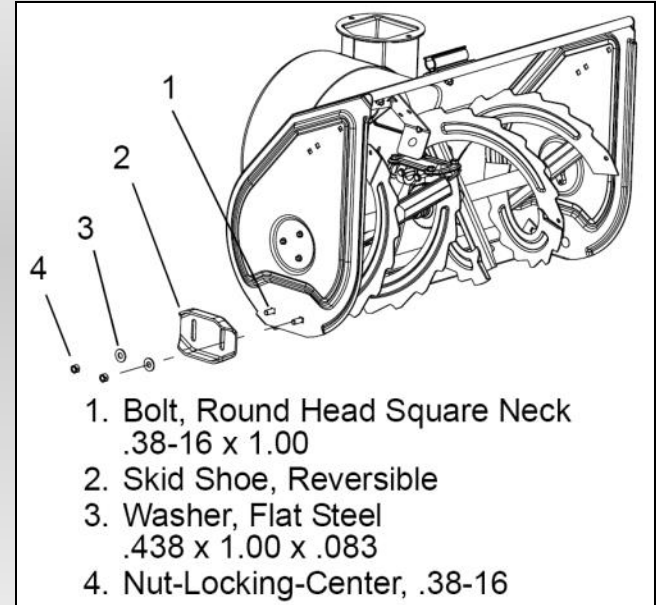



Step Seven: Check Function of Dual Handle Interlock

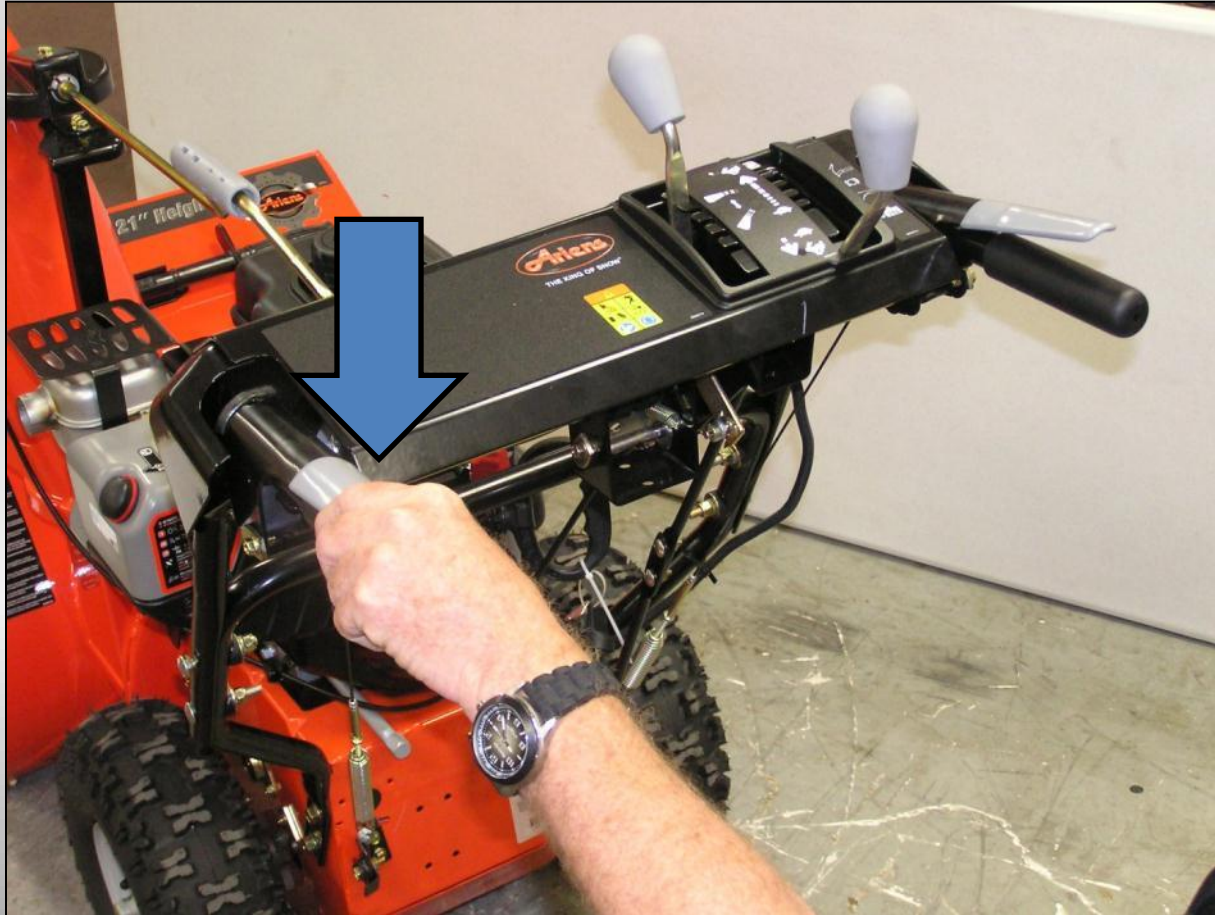

Without the engine running, press down (engage) both clutch levers. Release attachment clutch lever. Attachment clutch should remain engaged until traction clutch lever is released, then both clutches *must* disengage. If they do not, contact your dealer for repairs.



Step Eight: Check Tire Pressure



Check tire pressure and adjust to the pressure listed on tire sidewall.



Step Nine: Check Auger Gearcase Oil

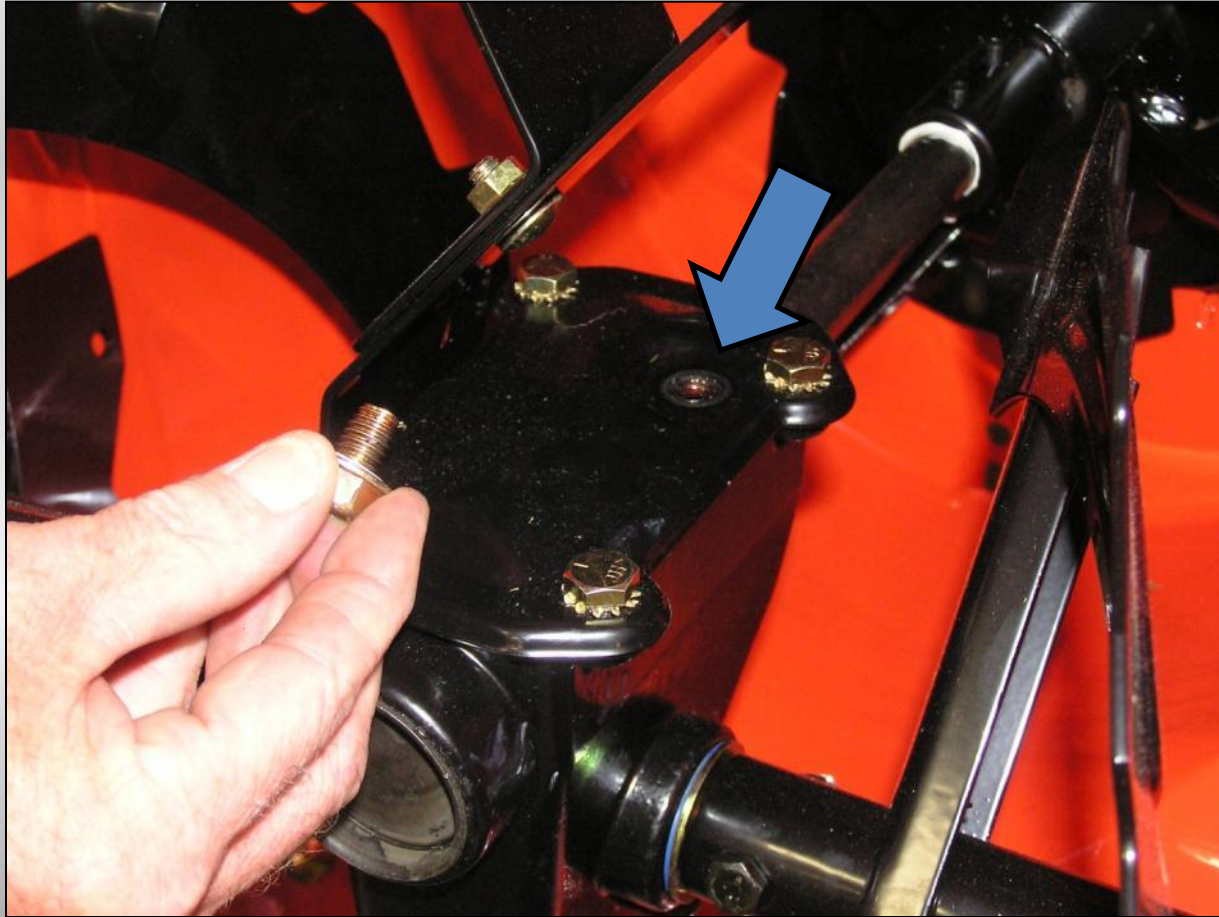

Check oil level in auger gearcase (see *Check Auger Gearcase* in Owners Manual).



Step Ten: Check Engine Crankcase Oil (Ariens AX)



IMPORTANT: The engine is shipped with 5W-30 oil in crankcase. Refer to engine manual for detailed instructions.



Step Twelve: Fill Engine Fuel Tank (Ariens AX)



Fill fuel tank. DO NOT OVERFILL! See *FILLING FUEL TANK* in Owners Manual.



Step Thirteen: Starting the Engine (Ariens AX)





Starting Engine / Step A: Choke



Turn throttle all the way up. Turn choke ON.



Starting Engine / Step B: Rocker Switch

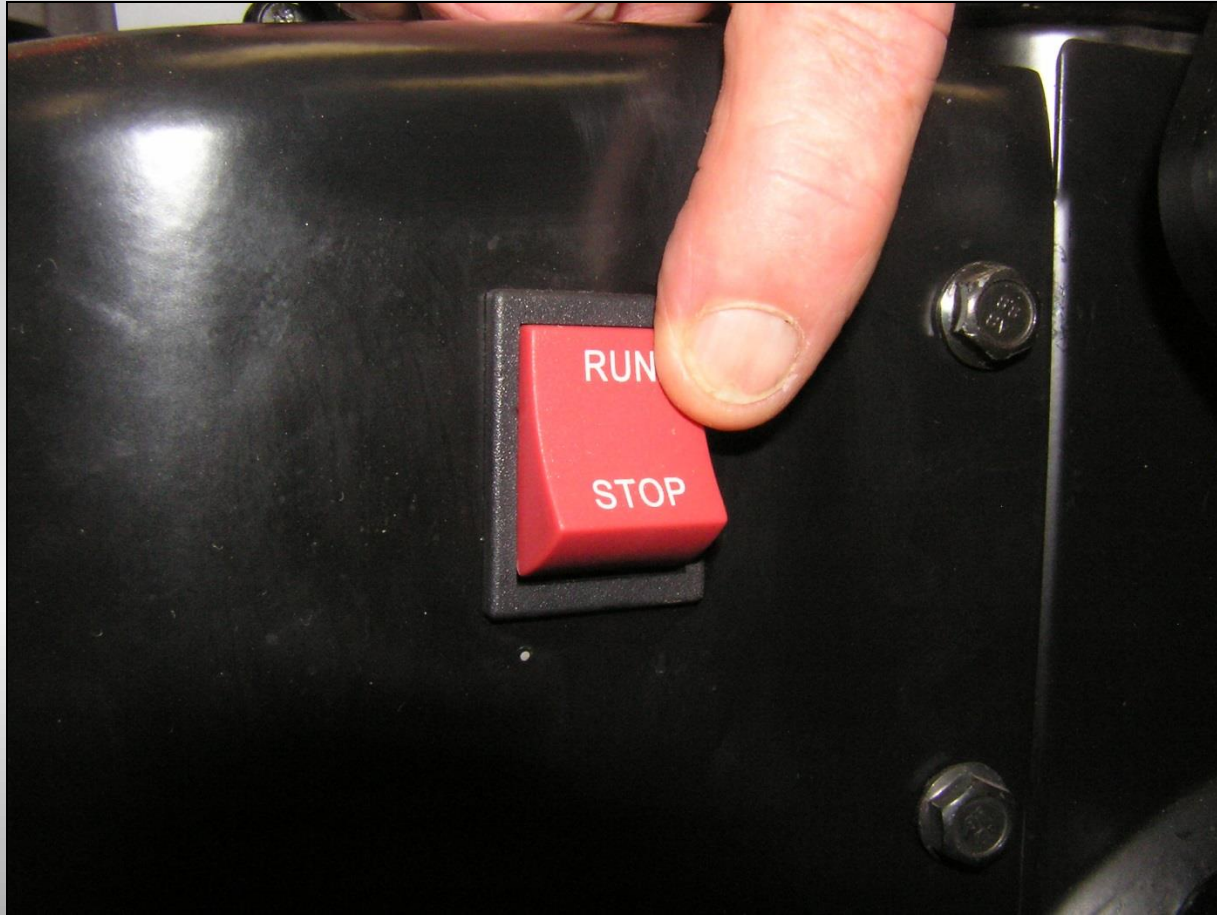

Push rocker switch
to RUN position.

Starting Engine / Step C: Fuel Shut Off Valve

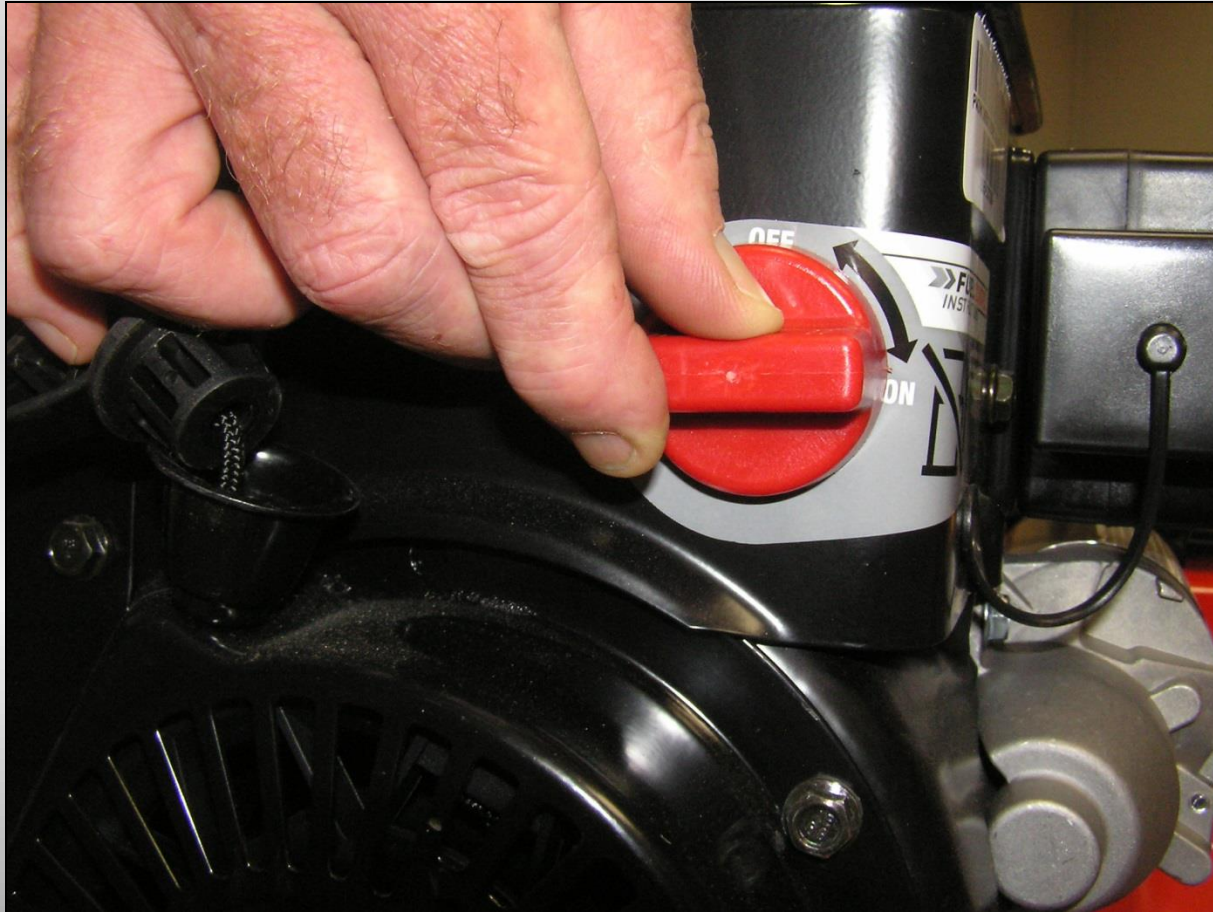

Turn fuel petcock
to ON position.



Starting Engine / Step D: Key



Install Safety Key Switch. Insert ignition key into slot but DO NOT turn the key. Be sure ignition key snaps into place.



Starting Engine / Step E: Prime

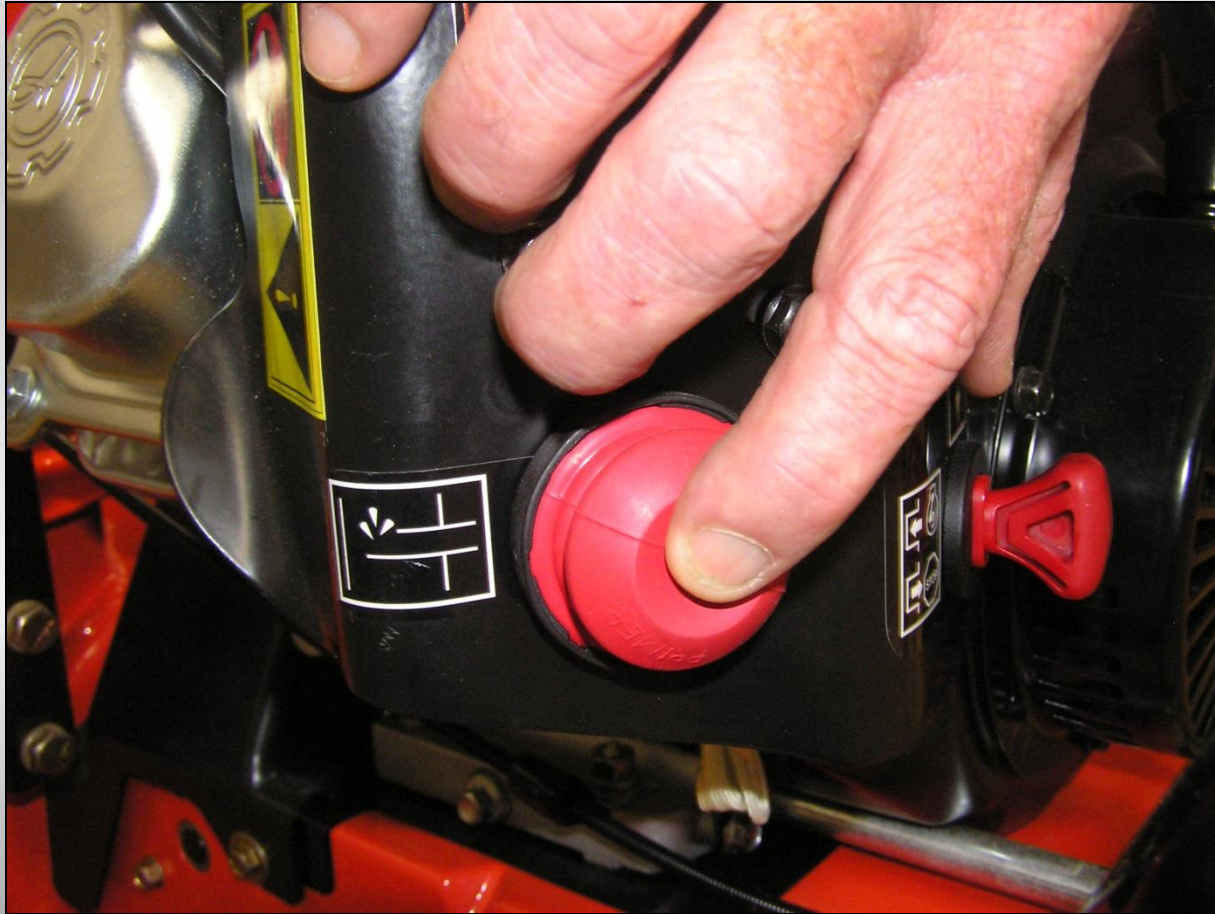

Prime system: 3 primes maximum. DO NOT over prime system. Make sure to cover the vent hole on primer bulb before the primer bulb is compressed. Hold the primer bulb in the compressed position for one full second each time you press it. Repeat for a total of 3 primes.



Starting Engine / Step F: (Manual Start)



Grasp rope handle. Pull slowly until resistance is felt, then pull rope firmly and quickly to start engine and avoid kickback.



Starting Engine / Step F: (Electric Start)



Use a 3-wire extension cord and plug cord into starter motor adaptor first. Then plug cord into wall receptacle. Use appropriately sized extension cord (10AWG or larger) to prevent damage to electric starter.

Starting Engine / Step G: (Electric Start)



Press and hold starter button.

Note: Do not hold the electric starter button down for more than 5 seconds. Wait at least 1 minute before additional starting attempts.



Starting Engine / Step H: Warm up



Allow the engine to warm up for 1-2 minutes, move the choke control to the **CHOKE OFF** position.



Step Fourteen: Stopping the Engine (Ariens AX)



To stop engine in an emergency, flip the Rocker Switch to the STOP position, OR Pull Safety Key from Engine.

Under normal conditions:

1. Turn throttle down.
2. Push rocker switch to STOP position.
3. Pull safety key OUT.



Additional Resources

- Refer to Owners Manual and Engine Manual
- Contact Ariens Company

www.ariens.com

Phone: 920-756-4688

E-mail: info@ariens.com